

# PrimeStore® MTM

Self-contained, ready-to-use system that allows for the stabilization and safe transport of clinical samples at ambient temperature from the collection site to the laboratory.

## Intended use

PrimeStore® Molecular Transport Medium (PS-MTM) is intended for stabilization, transportation, and inactivation of infectious unprocessed nasal washes, nasopharyngeal swabs, and oral/throat swabs suspected of containing Influenza A virus RNA. PS-MTM is also intended for the stabilization, transportation, and inactivation of infectious unprocessed sputum samples suspected of containing *Mycobacterium tuberculosis* (MTB) DNA from human samples.

*Optimal storage  
temperature 2-25°C*

## Specimen collection procedure

Non invasive collection of suitable clinical/biological samples including nasal washes and sputum samples. Collect clinical/biological specimens using standard clinical procedures.

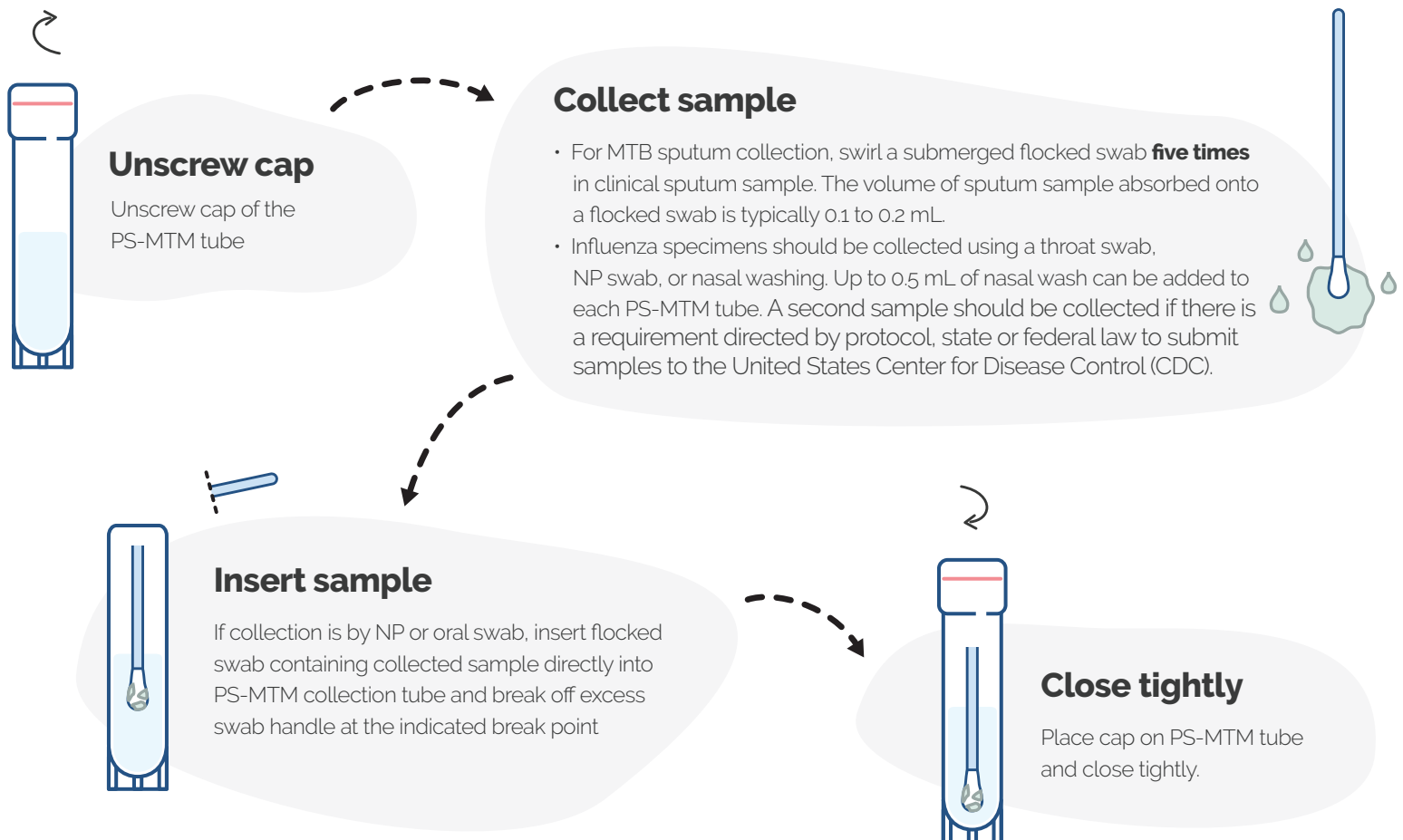

## Store sample

Store at room temperature until ready to ship to diagnostic laboratory. MTB DNA from samples collected and stored in PS-MTM is **stable for up to 30 days** at ambient temperature (10-26°C). Influenza A RNA from samples collected and stored in PS-MTM is **stable for up to 7 days** at ambient temperature (26°C) or can be refrigerated for up to 28 days.

**Proceed with RNA/DNA extraction** after letting specimen sit in PS-MTM for a **minimum of 60 minutes**. Vortex sample before use. Extract the RNA/DNA using extraction kit or an automated platform validated for use with PS-MTM.

## Precautions

- ✓ To be used by trained and qualified professionals.
- ✓ Read the information in this package insert and follow directions carefully.
- ✓ Refer to product Safety Data Sheet (SDS) for safe handling procedures.
- ! Do NOT mix with strong acids, alkalis, or oxidizing agents. Contact with acids liberates toxic gas.
- ! Do NOT insert swab into solution before collecting patient specimen.
- ! Do NOT drink, touch or remove PS-MTM from collection tube.
- ! Do NOT transfer PS-MTM into other tubes.
- ! Do NOT pool PS-MTM into larger volumes, or leave tubes uncapped for more than 10 minutes.
- ! For specimen in PS-MTM follow state, local and institution guidelines for the handling and disposition of biohazard waste.
- ✓ **Shelf life:** 24 months from manufacture.

## Limitations

- Performance characteristics of PS-MTM have been demonstrated for Influenza RNA and MTB DNA. The user is responsible for validating PS-MTM with all diagnostic assays to include those used in this submission.
- Performance characteristics of PS-MTM have been demonstrated for Influenza RNA from nasal washes and MTB DNA from sputum.
- The user is responsible for establishing appropriate system performance characteristics for other specimen types and tissues.
- The PS-MTM system is a collection, preservation, transport, and storage system for Influenza RNA and MTB DNA Extraction and purification of nucleic acids have been validated on several manual spin column kits (PrimeXtract™ RNAqueous Micro Kit, Viral RNA Mini Kit, QiaAMP DNA Mini Kit) and automated magnetic bead extraction kits (NucliSENSE EasyMAG and MagNA Pure g6 System using the DNA Bacterial/Viral small volume kit). The user is responsible for validating additional extraction and purification kits and platforms.

## Reagents

Guanidine thiocyanate, TCEP, Sodium citrate, N-Lauroylsarcosine (NLS) sodium, Antifoam A, TRIS, EDTA, Ethanol (molecular grade), HCl, Nuclease-free water.

## Test Accuracy

Accuracy of molecular testing depends on proper specimen collection, integrity of nucleic acid, extraction and PCR amplification.



## NEED HELP?

Contact technical support with questions

[support@vmrd.com](mailto:support@vmrd.com)